

Block overlap to be minimum 100mm



Depth of chasing not to be greater than 1/3 of wall thickness (generally snug fit)

Horizontal joints to be completely filled

Control joint ties to be placed at every second course, crimp always facing up

Block damage to be repaired with Hebel adhesive & Hebel Dust mixed to a Patching Paste

All fixings to be an approved type

Joint thickness to be 2-3mm using Hebel thin bed Adhesive

Control joints allowed for @ 6000mm maximum centres

Excess adhesive to be removed

Sand cement thin bed mortar

DPC slip joint membrane to all walls on a support

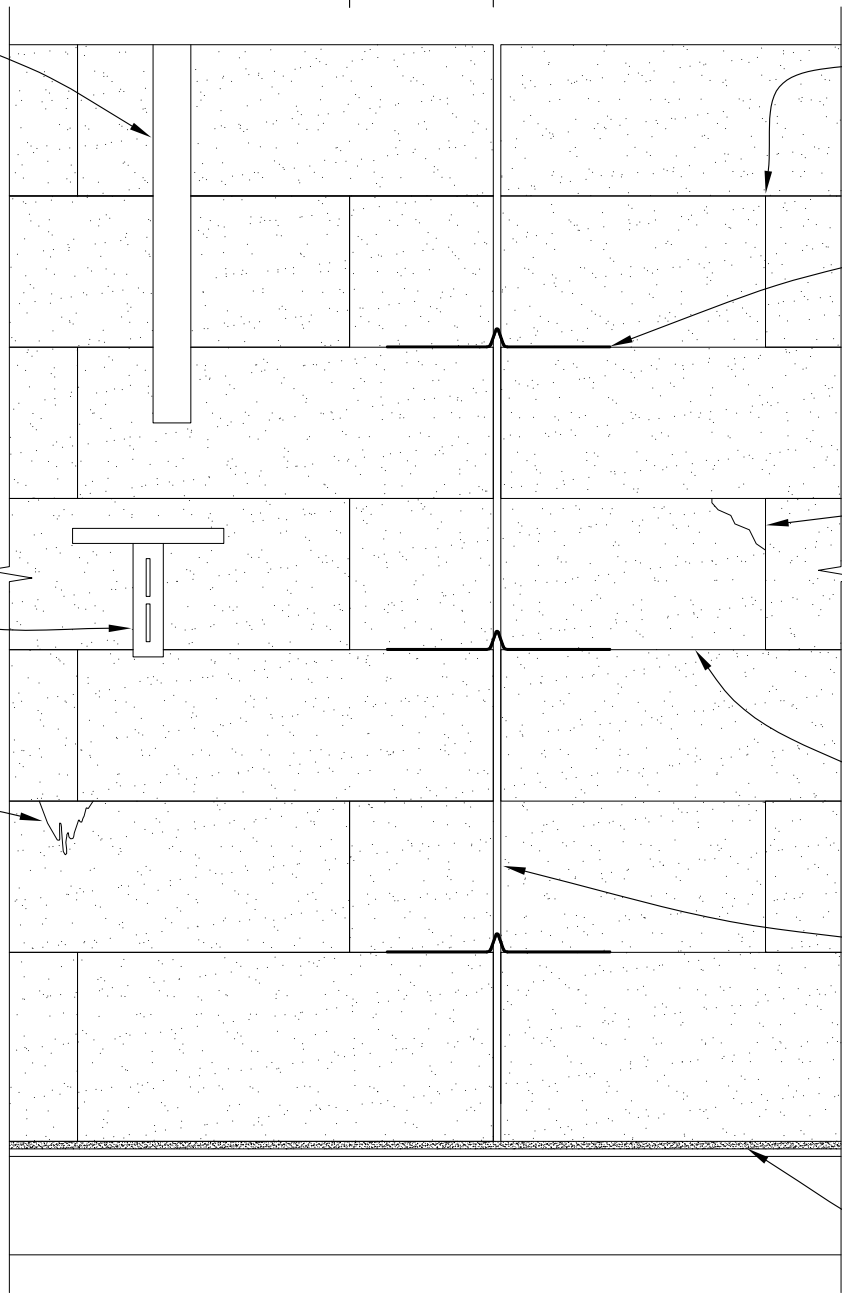

Lightweight Concrete NZ Ltd
67 Reid Rd., PO Box 2398, Dunedin
Ph 03 455 1502 www.hebel.co.nz

Title: Wall Construction Checklist		
Date: June 2007	Scale: 1:10	Detail No. BLK- 1.2

This drawing must be read in conjunction with the Technical Manual